



Fill in your personal details now.

This card is used during the Nagoya University disaster preparedness training in fall.

Evacuee check card

For use during drill

Drill procedure

Earthquake Early Warnings

1

Take safety Action
(2 minutes)

2

Evacuate once the earthquake tremors have ended

3

Check on evacuees
(submit evacuee check card)

Submit the card to faculty members or staffs after successfully evacuating to the primary evacuation area

Evacuee check card

For use during disasters

Fill in
your personal details
now.

This card is used as a
record that you evacuated
safely during a major
earthquake, fire, and accident.

Enter your personal information ahead
of time. Tear off and submit to faculty
members or staffs once you have arrived
at the primary evacuation area.

An earthquake strikes!
Intense shaking will last few minutes
Keeping yourself safe should be your first priority



Precautions

Fix the heavy and large furniture.
Prevent falling and breakage of chemicals.
Keep three days supply of water and food.



Safety Actions



DROP!



COVER!



HOLD ON!

Protect your head from falling objects. Stay away from: Large furniture and large laboratory equipment and glass objects that may shatter. Keep calm in case of a power outage.



Evacuate to Safe area

When the shaking stops

Stay Calm, support others, and accurately assess the situation.

- (1) Assess the situation in the room.
- (2) If there is a fire, work together to start controlling it as long as you can stay safe.
- (3) If anyone is injured, work together to provide first aid as long as you can stay safe.
- (4) Shut off light and power/gas lines.
- (5) Do not use elevators.

If you are in an elevator, press every button and get off the elevator immediately after the door opens.



Follow instructions from the faculty members and
evacuate to a safe area. (See map)



Evacuee Safety Confirmation

After reaching the evacuation area, please hand in the Evacuee confirmation card to the staffs of each building.



Helpful information in an emergency

Confirm your safety:

Emergency message hotline: 171

●Dial 171 from a cell phone or public phone for the emergency message hotline. ●Registering your safety status (audio recording) ●171+1+your phone number → leave a message ●To hear others' messages (audio playback) ●171+2+ the person's phone number → hear the recorded message

Disaster message board (provided by mobile phone companies)

●Access the disaster message board from the company's official portal site ●Free trial on the first and fifteenth day of each month.

If your LINE message status is "read", your safety is confirmed.

Disaster info

Twitter Collect disaster information tweets from the Meteorological Agency, fire department headquarters, the municipal government, and other officials.

Rajiru★Rajiru, radiko.jp

Smartphone app for online radio broadcasting

Always carry an LED light, writing materials, portable battery charger, etc. in your bag.

Register Now!

Follow these steps to make safe
evacuation checks go smoothly.
This card is also used for disaster
preparedness training.

1 Registering your email address for emergency contact

Use the "Yearly Information Security Check" which is mandatory for students and faculty members, to register your email

2 The university will send a group email to registered email address should a disaster occur.

You will get an email at your registered address should a disaster occur.

3 Enter your safety status

When you receive the email, follow the instructions to enter your safety status.

Deciding whether to
return home

You may not be able to walk via your
normal route due to collapsed
buildings and crumbled roads. If
necessary, you may have to make the
decision not to go home if you live
more than 10 km away.

Going home

- Do you know the distance between the university and your home?
- Do you wear shoes safe enough to walk roads scattered with wreckage and glass?

At convenience stores with the stickers on the back, you may be able to receive tap water or toilet when you come home on foot during a disaster.



Deciding not to go home

Another option is to stay in a safe place
instead of immediately going home.

When Nankai Trough Earthquake Extraordinary Information has been issued by Japan Meteorological Agency

Get the correct information by yourself and
check Nagoya University website for classes
and university activities.

When the storm warning has been issued :

If a "Storm (Gale) Warning" for Nagoya City is issued by Japan Meteorological Agency (JMA), classes will be cancelled after the warning issuance. If the warning is subsequently lifted, classes will be held as follows:

- If the warning is lifted by 6:45 am, classes will be held as scheduled.
- If the warning is lifted by 11:00 am, afternoon classes will be held.

When the "Emergency Warning" is issued by JMA:

Immediately follow the evacuation information
of local municipalities.

Carry At All Times

What to do in a major earthquake!

Plan ahead. Prepare Now

2020 version



When an emergency earthquake warning is issued

You have between several seconds and a
few dozen seconds before the strong
quake strikes.



DO NOT START RUNNING. DO NOT PANIC.
Calm down and look for a safe place.



NAGOYA
UNIVERSITY

When an emergency earthquake warning is issued on campus

Do not panic. Protect yourself
Calm down. Follow instructions of the
faculty members to evacuate.
As soon as you are safe, report your status
to others.

Go home once you get accurate
information on the situation.



immediately in case of fire,
sudden illness, accident,
or other emergencies.

◆Higashiyama Campus
mobile phone 052-789-2111
Dial extension 110, 119

◆Tsurumai Campus
Call Emergency Control Center
mobile phone 052-744-2939
Dial extension 5555

◆Daiko Campus
for student 052-719-1518
Also call 119 in case of fire or sudden illness

Department of Advising &
Counseling Services, International
Education & Exchange Center
TEL 052-788-6117

NAGOYA UNIVERSITY Evacuation area MAP

Higashiyama Campus

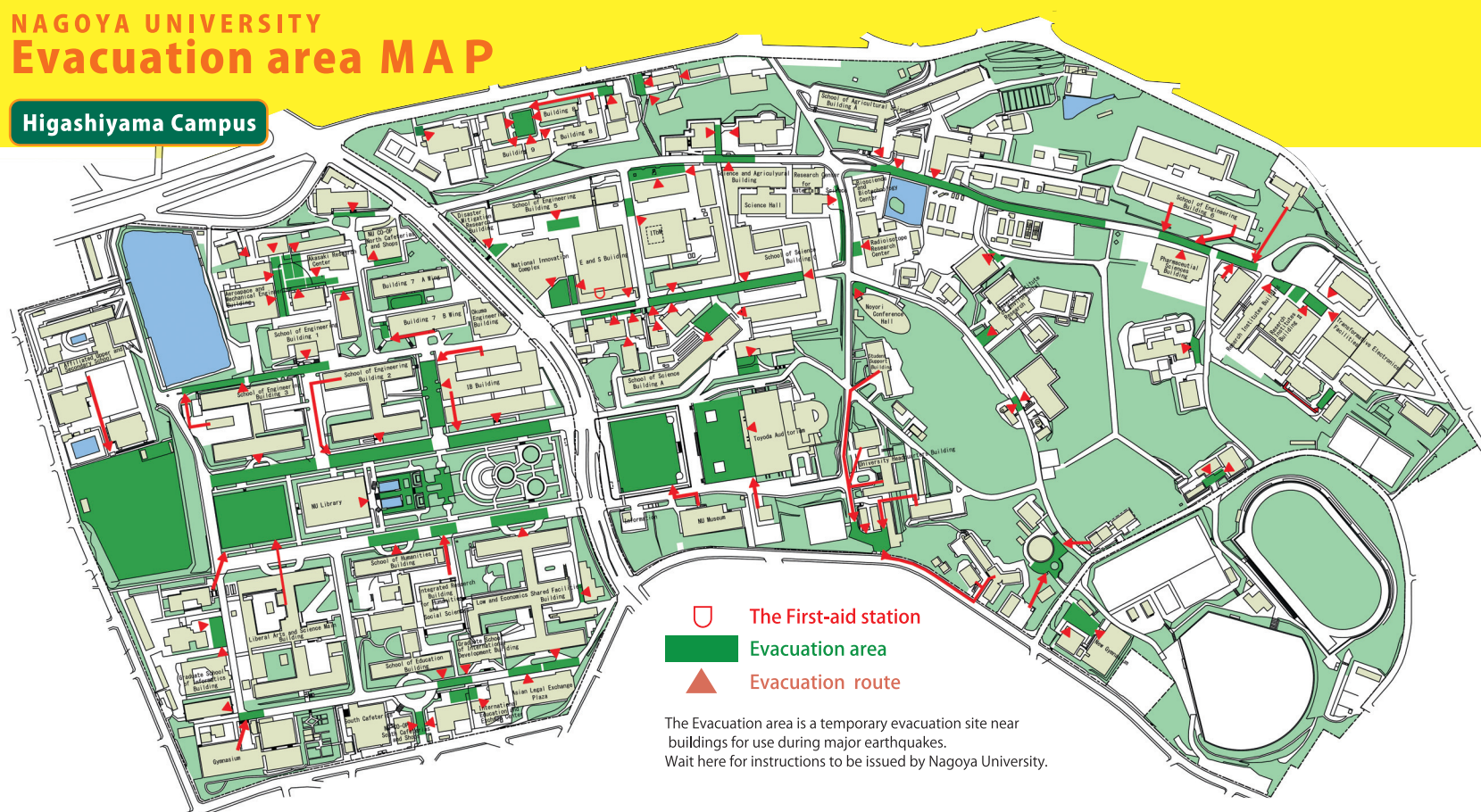

The First-aid station

Evacuation area

Evacuation route

The Evacuation area is a temporary evacuation site near
buildings for use during major earthquakes.
Wait here for instructions to be issued by Nagoya University.

Tsurumai Campus

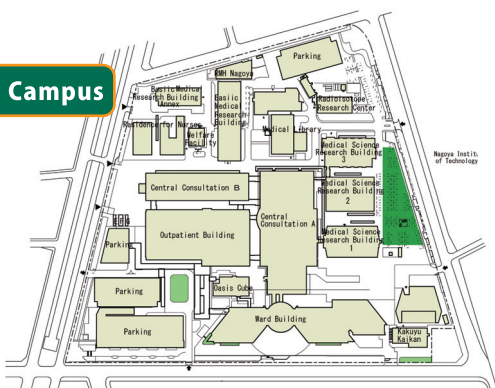

Daiko Campus

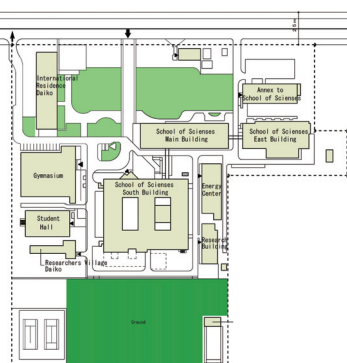

Fill in your personal
details now.

For use during drill

Evacuee safety Confirmation

☐ Student ☐ Staff ☐ Other

Name

Affiliation

School / Graduate School / Department / major

Status

Grade

Student ID

Staff ID

To be filled by the University



Fill in your personal
details now.

For use during disasters

Evacuee safety Confirmation

☐ Student ☐ Staff ☐ Other

Name

Affiliation

School / Graduate School / Department / major

Status

Grade

Student ID

Staff ID

To be filled by the University